

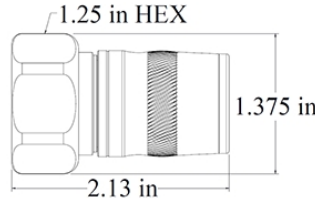

UXP-DM-12

7-16 DIN Male Connector for 1/2" Annular Cable



[Installation video](#)



[Installation instructions](#)



Contact technical support:

1-888-201-6073

techsupport@jmawireless.com

General		Specification	
Interface/gender	7-16 DIN male		
Cables supported¹	Manufacturer	P/N	Manufacturer
	JMA Wireless	JMA12-50	Wireless Supply
		JMA12R-50	
	CommScope	LDF4	Eupen
		LDF4RK	
		LDF4 RN	LS/Superior Essex
	RFS	LCF12	
		LCF12-50JL	Hansen
NK Draka	RFA1200		
Rosenberger	SL 1/2" R	Belden	
Weight	0.311 lb 141.1 g		
JMA Weather Protection System	Boot: WPS-4A Port seal: WPS-DF		
Tools required	JMA part number	Comment	
Cable preparation	SP-1/2-LDF4D	"U" bit	
Torque wrench	TQ-114-F18	18 lbf-ft 24.4 N·m	
Connector compression options	Compression tool	Frameset	Insert
	HCG-CC (RP 240 / RP 210-B / RP 100-B)	HCG-FS-12-01	HCG-INS2-12-01 (Insert 2)
	HCG-CC (RP 240 / RP 210-B / RP 100-B)	HCG-FRAMESET-1/2	HCG-INSERTA-1/2 (Insert A)
Frequency band	VSWR	Return loss (dB)	
DC-1000 MHz	1.02	40	
1000-2000 MHz	1.03	36	
2000-4000 MHz	1.05	32	
4000-6000 MHz	1.08	28	
Electrical	Specification	Comment	
Connector impedance	50 ohm		
Operating frequency band	DC-6 GHz		
3rd order IMD dynamic, (PIM)	-161 dBc, typical	IEC 62037-2	
DC test voltage	4000 V		
Center contact resistance	≤ 0.8 milliohm		
Outer contact continuity	1.5 milliohm max.		
Average power	1100 W @ 900 MHz		
Peak power, max.	40 kW		
Insertion loss, typical	0.05 dB	Per connector	
Shielding effectiveness	< -120 dB	@ 0-1 GHz	
Mechanical	Specification	Comment	
Pull force combined	1.1 kN >250 lb	Cable limited	
Cable retention torque	6.7 N·m 5 lbf-ft	Cable limited	
Interface durability	500 cycles	IEC 61169-4:9.5	

¹For cable types not listed, please contact JMA Technical Support.



UXP-DM-12

7-16 DIN Male Connector for 1/2" Annular Cable

Environmental	Specification	Test
Operating temperature	-55 °C to +85 °C (-67 °F to 185 °F)	
Storage temperature	-55 °C to +85 °C (-67 °F to 185 °F)	
Accelerated UV	1000 hr	ASTM G154
Immersion test method	Mated & unmated, IP68	IEC 60529:2001 & ANSI/SCTE 60
Water jetting test method	Mated & unmated, IP66	IEC 60529:2001
Mechanical shock test method	Pass	IEC 60068-2-27
Thermal shock test method	Pass	IEC 60068-2-14
Vibration test method	100 m/s ² , 2 Hz to 200 Hz	IEC 61169-1:2003
Corrosion test method	1000 hr	IEC 60068-2-11

04/21/26