

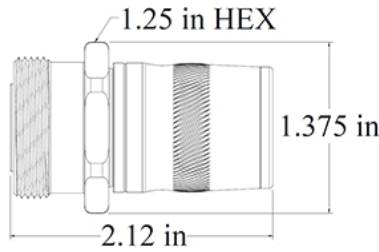

UPL-DF-12T

7-16 DIN Female Connector for 1/2" Trilogy Plenum Cable



[Installation video](#)



[Installation instructions](#)



Contact technical support:
1-888-201-6073
techsupport@jmawireless.com

General		Specification					
Interface/gender		7-16 Female					
Cables supported¹	Manufacturer		P/N				
	Trilogy		AP6012J50				
			APC012J50				
			AC012R50				
			AC012J50				
			AP012U50				
			ACC012J50				
		ACC012R50					
Weight		140.2 g 0.309 lb					
JMA Weather Protection System		N/A					
Tools required		JMA part number		Comment			
Cable preparation		SP-12PL-01					
Hex width				32 mm 1-1/4 in.			
		Compression tool		Frameset		Insert	
Connector compression options		HCG-CC (RP 240 / RP 210-B / RP 100-B)		HCG-FS-12-01		HCG-INS2-12-01 (Insert 2)	
		HCG-CC (RP 240 / RP 210-B / RP 100-B)		HCG-FRAMESET-1/2		HCG-INSERTA-1/2 (Insert A)	
Frequency band		VSWR		Return loss (dB)			
555–1000 MHz		1.02		40			
1000–2700 MHz		1.03		36			
2700–3800 MHz		1.05		32			
3800–6000 MHz		1.08		28			
Electrical		Specification		Comment			
Connector impedance		50 ohm					
Operating frequency band		DC–6 GHz					
3rd order IMD dynamic, (PIM)		-161 dBc, typical		IEC 62037-2			
DC test voltage		4000 V					
Center contact resistance		≤ 0.8 milliohm					
Outer contact continuity		1.5 milliohm max.					
Average power		1100 W @ 900 MHz					
Peak power, max.		40 kW					
Insertion loss, typical		0.05 dB		Per connector			
Shielding effectiveness		< -120 dB		@ 0-1 GHz			
Mechanical		Specification		Comment			
Pull force combined		.89 kN > 200 lb		Cable limited			
Cable retention torque		6.7 N·m 5 lbf·ft		Cable limited			
Interface durability		50 cycles		IEC 61169-4:9.5			

¹For cable types not listed, please contact JMA Technical Support.



UPL-DF-12T

7-16 DIN Female Connector for 1/2" Trilogy Plenum Cable

Environmental	Specification	Test
Operating temperature	-55 °C to +85 °C (-67 °F to 185 °F)	
Storage temperature	-55 °C to +85 °C (-67 °F to 185 °F)	
Accelerated UV	1000 hr	ASTM G154
Immersion test method	Mated & unmated, IP68	IEC 60529:2001 & ANSI/SCTE 60
Water jetting test method	Mated & unmated, IP66	IEC 60529:2001
Mechanical shock test method	Pass	IEC 60068-2-27
Thermal shock test method	Pass	IEC 60068-2-14
Vibration test method	100 m/s ² , 2 Hz to 200 Hz	IEC 61169-1:2003
Corrosion test method	1000 hr	IEC 60068-2-11

05/05/26