

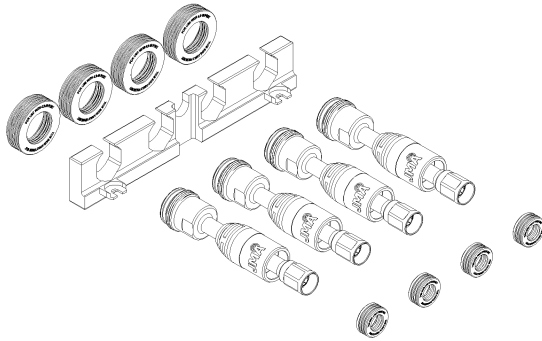

# KIT-4F1MW-E

## 4.3-10 Female to NEX10 Male Low-Loss Connector for Adapter Kit for E/// RRU 4402



[Installation video](#)



Contact technical support:  
1-888-201-6073  
[techsupport@jmawireless.com](mailto:techsupport@jmawireless.com)

### Features

- Mates to Ericson 4402 Radio NEX10 connectors
- WPS protection with both standard 4.3-10 & NEX10 port seals
- Seals to 4M connector outside housing with standard 4F port seal
- Aluminum mounting bracket extends outside protective cover, secures with rotation resistance to housing
- Packaged as Kit of 4 adapters with WPS, plus port seals, plus mounting bracket
- Can be ordered as a Kit or individually as a component

General	Specification				
Interface/gender	4.3-10 Female to NEX10 Male Low-Loss Connector Adapter Kit for E/// RRU 4402				
Kits comprised of:	Manufacturer	P/N	Description	Quantity	UoM
	JMA	JMA-4F1MW-E	Adapter, 4.3-10 Female to NEX10 Male with WPS	4	pcs
		WPS-4F	PORT SEALS, 4.3-10, included with JMA-4F1MW-E	4	pcs
		WPS-1F	PORT SEALS, NEX10, pack of 2pcs	2	kits
		18478-01	TORQUE BRACKET	1	pcs
Weight of kit	0.74 lb   366.7 g				
Dimension of the Adapter (L x W)	3.55 x 0.79 in.   9.02 x 2 cm				
JMA Weather Protection System	Comes with the adapter				
Tools required		JMA part number		Comment	
Torque wrench		TQ-716-F3.7		3.7 lbf-ft   5.0 N·m	
Frequency band	VSWR		Return loss (dB)		
DC-1000 MHz	1.02		-40		
1000–2000 MHz	1.03		-36		
2000–4000 MHz	1.05		-32		
4000–6000 MHz	1.08		-28		
Electrical	Specification		Comment		
Connector impedance	50 ohm				
Operating frequency band	DC–6 GHz				
3rd order IMD dynamic, (PIM)	-161 dBc, typical; -155 dBc, min		IEC 62037-2, -3		
DC test voltage	1000 V				
Center contact resistance	≤ 1.0 milliohm				
Outer contact continuity	1.0 milliohm max.				
Average power	500 W @ 2 GHz				
Peak power, max.	13.2 kW				
Insertion loss, typical	0.05 dB		Per connector		
Shielding effectiveness	< -120 dB		@ 0-1 GHz		



## KIT-4F1MW-E

### 4.3-10 Female to NEX10 Male Low-Loss Connector for Adapter Kit for E/// RRU 4402

Mechanical	Specification	Comment
Interface durability	100 cycles	IEC 61169-4:9.5
Environmental	Specification	Test
Operating temperature	-55 °C to +85 °C (-67 °F to 185 °F)	
Storage temperature	-55 °C to +85 °C (-67 °F to 185 °F)	
Accelerated UV	1000 hr	ASTM G154
Immersion test method	Mated, IP68	IEC 60529:2001 & ANSI/SCTE 60
Mechanical shock test method	Pass	IEC 60068-2-27
Thermal shock test method	Pass	IEC 60068-2-14
Vibration test method	100 m/s <sup>2</sup> , 2 Hz to 200 Hz	IEC 61169-1:2003

10/08/25