

## 2-port 10 in. 65° panel antenna 617-3980 MHz

- 617-3980 MHz 2T2R antenna
- Ideal for in-building and venue coverage
- Pigtail connectors for ease of installation
- Low profile for enhanced aesthetics
- Flush-mount bracket

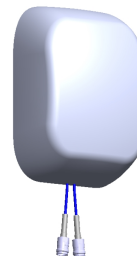

Electrical specification (min/max)	Ports 1, 2			Ports 1, 2				
Frequency bands, MHz	617-806	806-894	894-960	1695-1880	1850-1990	1920-2180	2300-2400	2496-2690
Polarization	± 45°			± 45°				
Maximum gain over all tilts, dBi	6.3	6.5	6.4	8.4	8.2	8.4	8.1	9.0
Average gain over all tilts, dBi	5.8	5.8	5.8	7.6	7.5	7.8	7.6	8.0
Horizontal beamwidth (HBW), degrees <sup>1</sup>	90	85	88	69	62	67	67	60
Vertical beamwidth (VBW), degrees <sup>1</sup>	90	85	88	69	62	67	67	60
Fixed electrical downtilt (EDT), degrees	0°							
Cross-polar discrimination (0°)	15	20	20	17	22	19	20	19.2
Cross-polar isolation, port-to-port, dB <sup>1</sup>	20			25				
Max VSWR / return loss, dB	1.8:1 / -11.0	1.8:1 / -11.0	2.0:1 / -10.0	1.6:1 / -13.0	1.6:1 / -13.0	1.6:1 / -13.0	1.6:1 / -13.0	1.6:1 / -13.0
Max PIM (3rd order, 2x20W) dBc	-150			-150				
Maximum input power port, watts	40			40				

Electrical specification (min/max)	Ports 1, 2
Frequency bands, MHz	3400-3980
Polarization	± 45°
Maximum gain, dBi	8.0
Average gain, dBi	7.0
Horizontal beamwidth (HBW), degrees <sup>1</sup>	57
Vertical beamwidth (VBW), degrees <sup>1</sup>	57
Fixed electrical downtilt (EDT), degrees	0°
Cross-polar discrimination (0°)	15
Cross-polar isolation, port-to-port, dB <sup>1</sup>	23
Max VSWR / return loss, dB	1.6:1 / -13.0
Max PIM (3rd order, 2x20W) dBc	-145
Maximum input power, watts	40

<sup>1</sup> Typical value over frequency.



# IX02PNL165-65

## NWAV™ X-Pol Antenna

### Mechanical specifications

Dimensions height/width/depth, inches (mm)	10.98/ 7.87/ 3.78 (279/ 200/ 96)
No. of RF input ports, connector type, and location	2 x 4.3-10 female, bottom
RF connector torque	96 lbf-in (10.85 N·m or 8 lbf-ft)
Net antenna weight, lb (kg)	1.3 (0.59)
Installation instructions	<a href="#">DX-*/SX-*/IX-* Antenna Mounting Instructions and Kits 81900511</a>
Weep hole drilling instructions	<a href="#">DX-*/SX-*/IX-* Antenna Weep Hole Modification Guide</a>

### Regulatory compliance/certifications

ROHS	Compliant. See <a href="#">JMA support page</a>
REACH	Compliant. See <a href="#">JMA support page</a>

### Dimensions

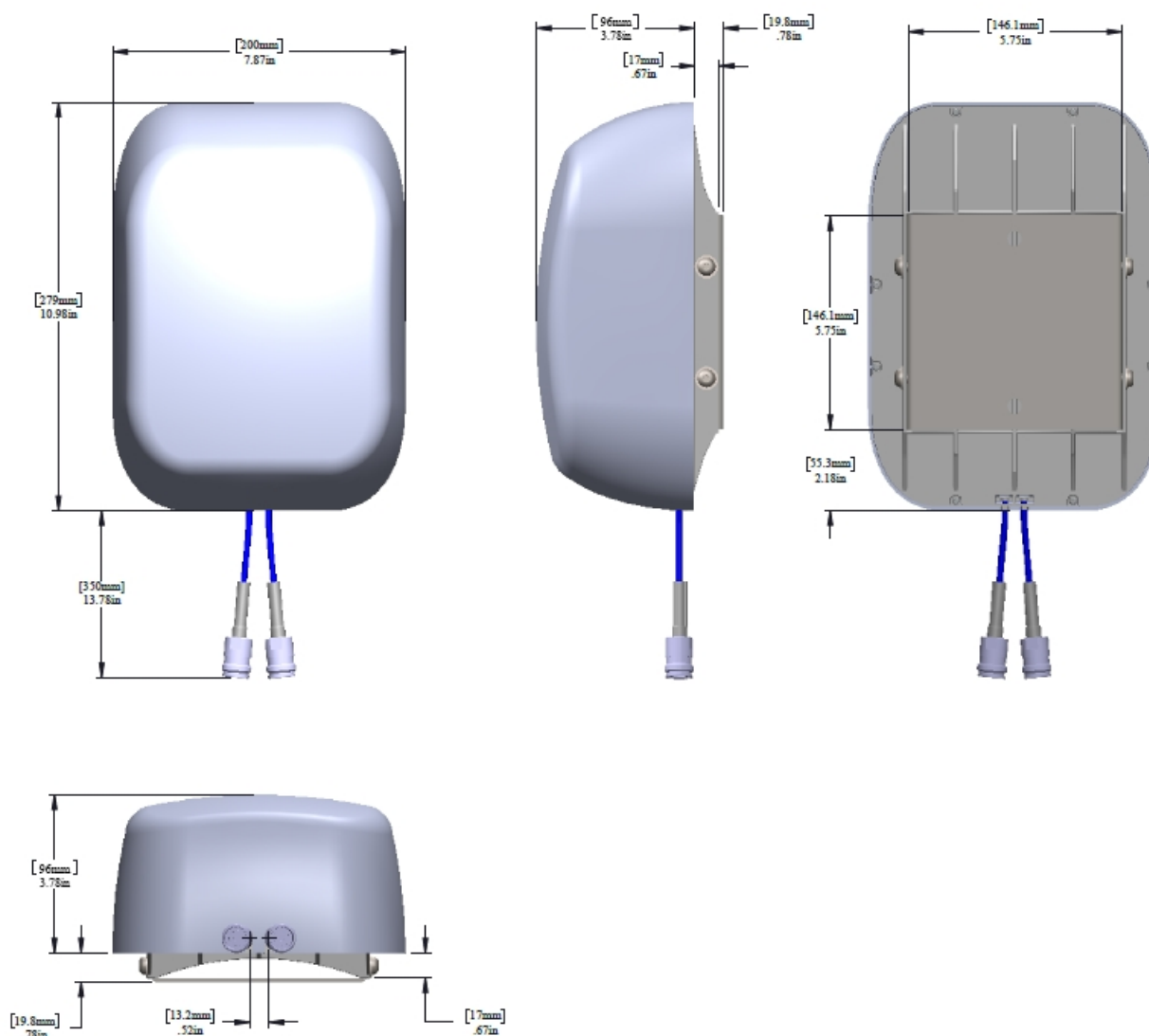

### Ordering information

Antenna model	Description
IX02PNL165-65	10 inch, 65 deg, 2 port panel antenna incl mount bracket